

REVISIONS		
Rev.	Date	By

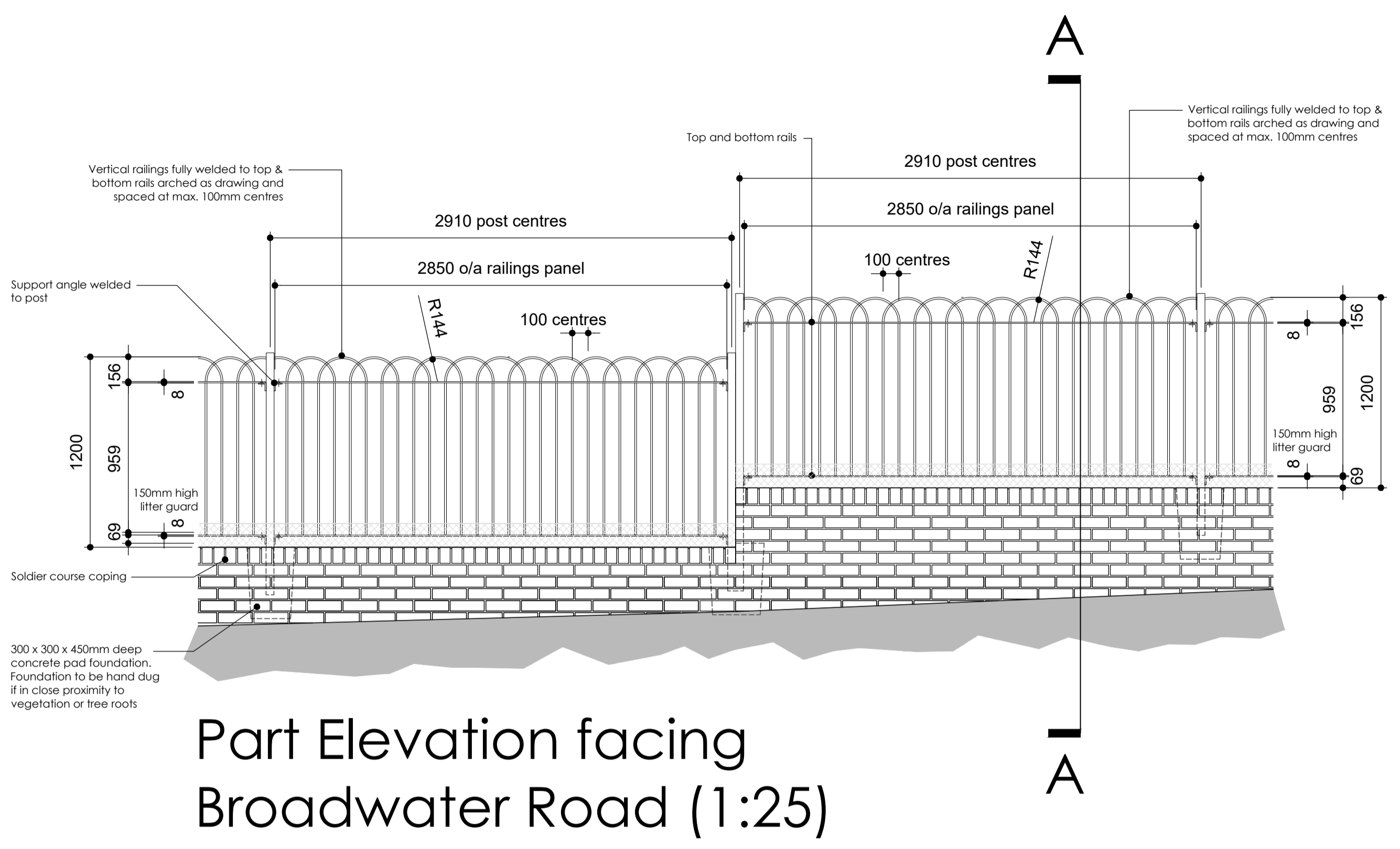

Part Elevation facing Broadwater Road (1:25)

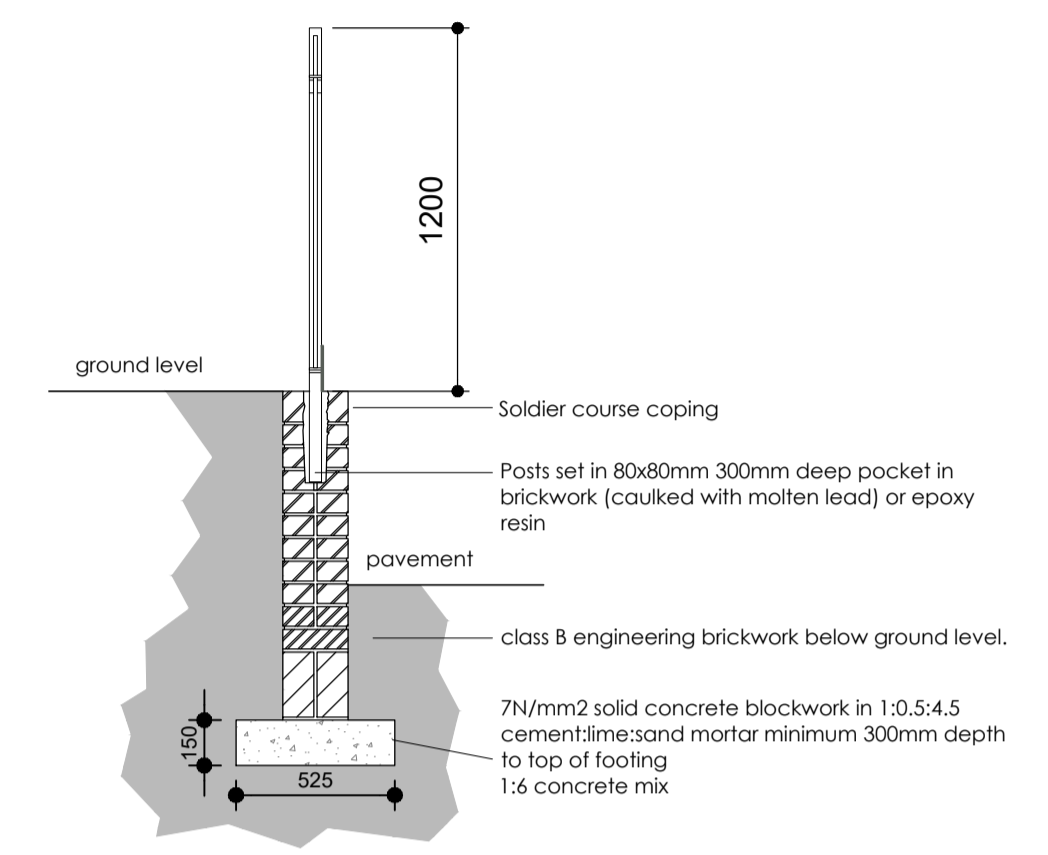

Section A-A (1:25)

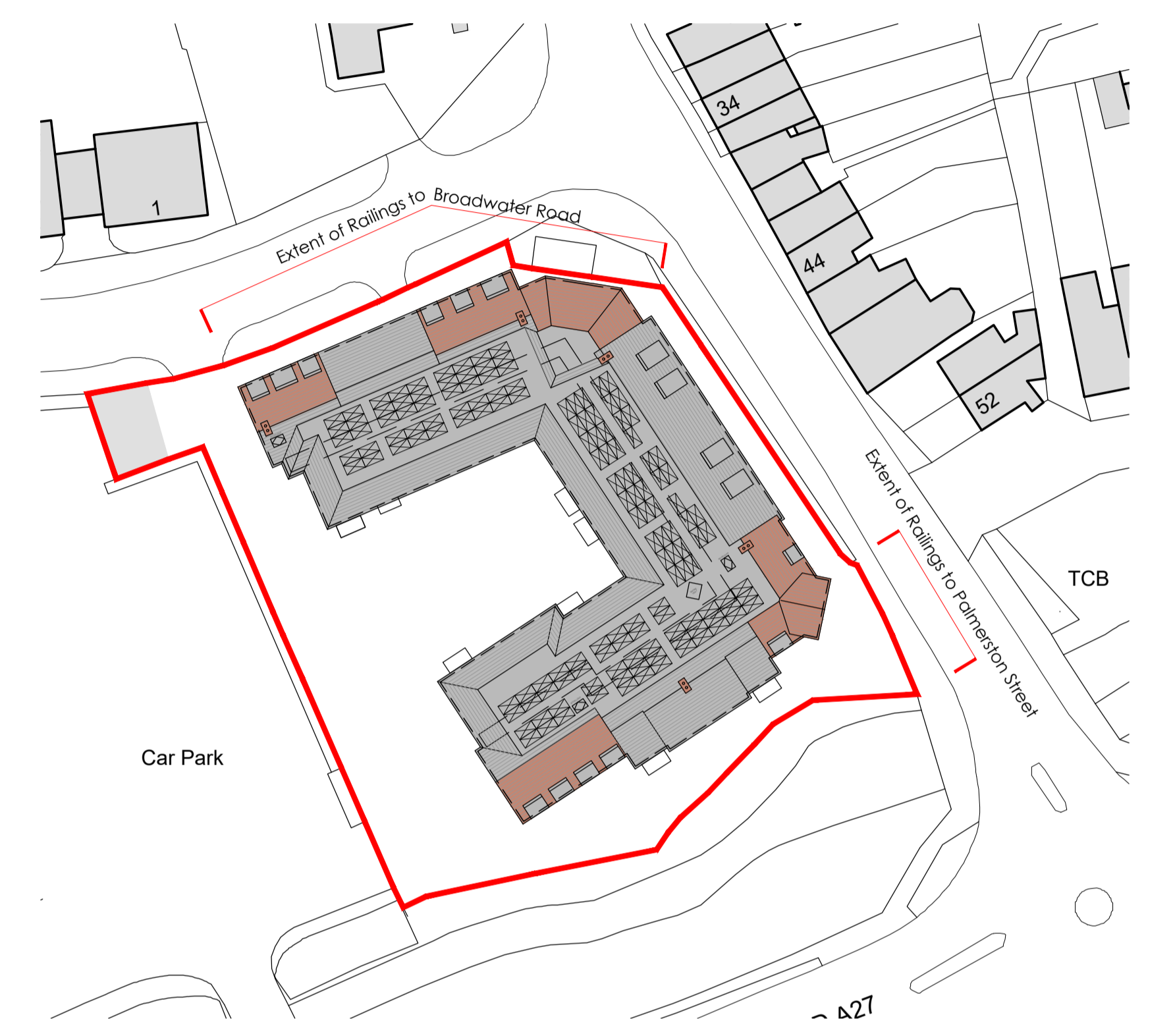

Part Plan (1:500)

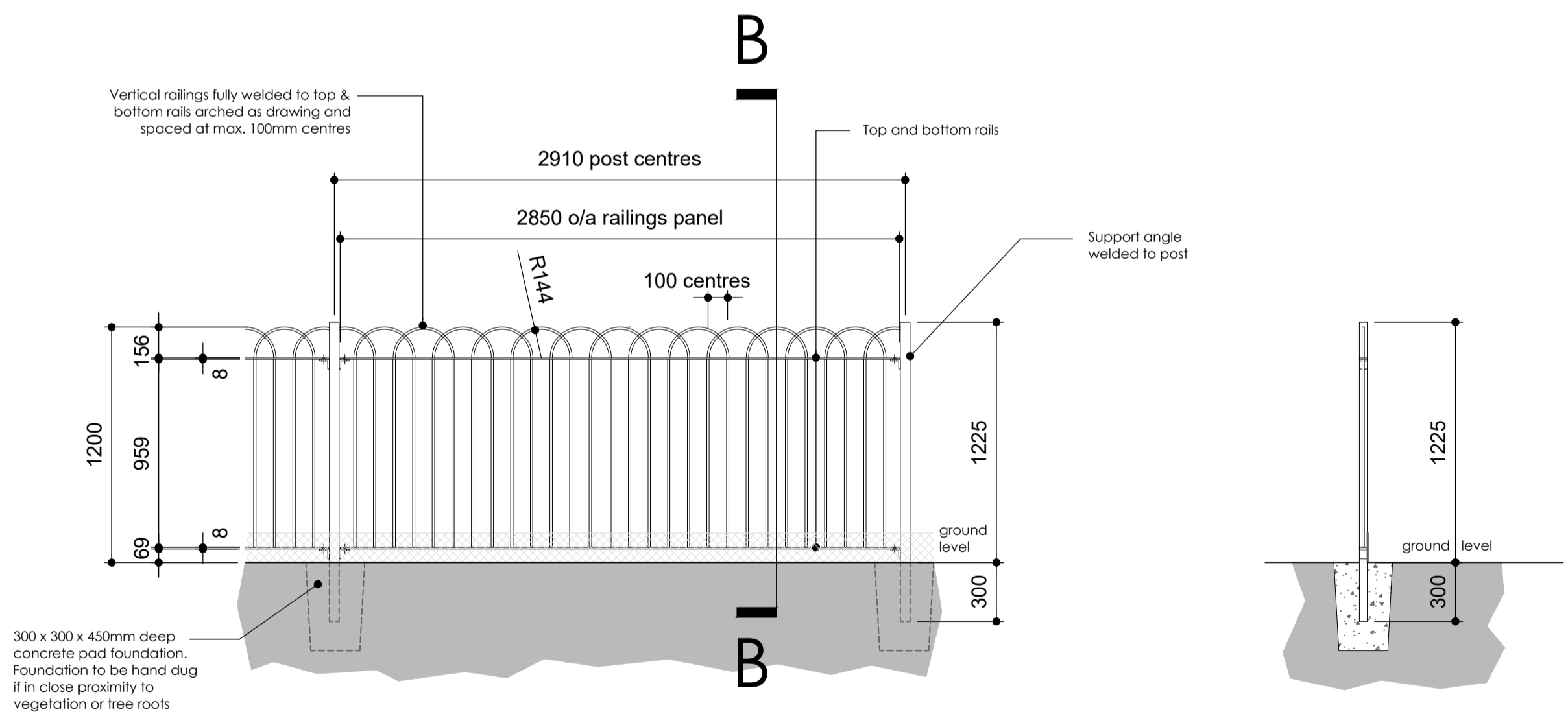

Part Elevation facing Palmerston Street (1:25)

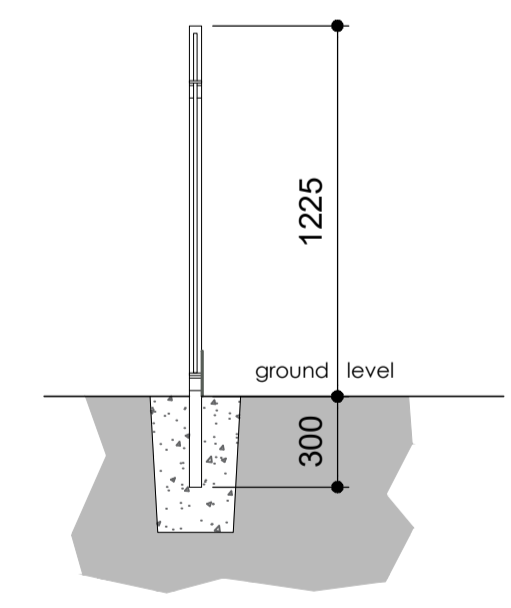

Section B-B (1:25)

Specification

- Materials:**
- Support posts - 50 x 50mm SHS
 - Top & bottom rails - 40 x 8mm MS flat
 - Vertical railings - 12mm Ø MS round
 - Support angles - 50 x 50 x 8mm MS angle, 40mm long
 - Fixings - M10 x 30mm SS bolt with nut & washers

Treatment/Decoration:
All steelwork to be galvanised and decorated with polyester powder coat paint finish, colour Black.

Notes:
12mm wide x 20mm long fixing slot in top face of MS support angles.

12mm Ø fixing hole at each end of top & bottom rails to correspond with fixing slot in support angles.

All dimensions to be checked on site prior to fabrication.



scale bar - metres

©CHURCHILL RETIREMENT LIVING

planning issues
TOWN PLANNING AND ARCHITECTURAL DESIGN
Rob Jackson RIBA

Churchill House * Parkside
Ringwood * Hampshire BH24 3SG
Telephone: (01423) 462109
Fax: (01423) 462101
E-mail: design@planningissues.co.uk

Client

Churchill Retirement Living

Project Title
Retirement Living Apartments
Edwina Mountbatten House - Broadwater Road
Romsey
SO51 8GH

Drawing Title
PROPOSED RAILINGS
PLANNING APPLICATION

Scale: 1:25 @ A1 Date: JULY 2023
Drawn: KLS Checked: RJ
Drawing No.: 10123RS - PA12 Rev.: -