

REVISIONS

Rev.	Date	By
A	Aug '23	KLS
General minor amendments. Roof over flat 40 lowered. Chimney added. Stone heads amended.		
B	Nov '23	KLS
General minor amendments. Roof over flat Guest Suite lifted. Brick quins omitted. Stone heads and cills omitted.		

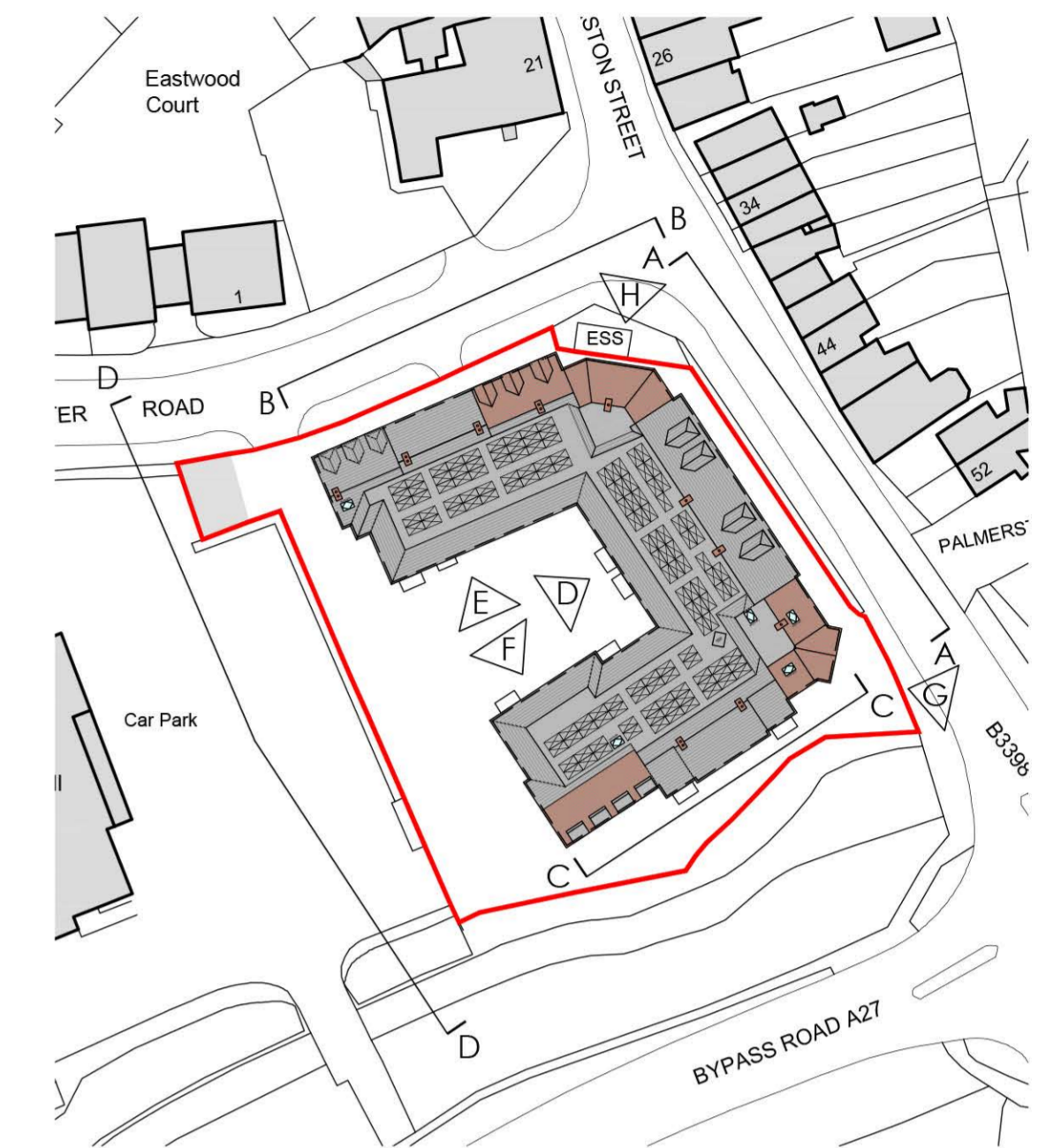

Bypass Road A27 Contextual Elevation



Key to Elevations



- 1 Prefabricated chimney
- 2 Natural slate roof tiles
- 3 Red clay roof tiles
- 4 Dormer windows
- 5 Black uPVC gutters and fascia
- 6 Red facing brick
- 7 Matching brick window heads & cills
- 8 Painted heads & cills
- 9 White-painted brickwork
- 10 Projecting GRP canopies over flat doors
- 11 Tax window
- 12 White uPVC casement windows
- 13 Painted metal balustrades
- 14 Feature cast stone entrance portico
- 15 Red clay tile hanging
- 16 Feature brick ribbon

car park

bypass road A27 elevation

palmerston st.

Elevation C-C facing Bypass Road A27

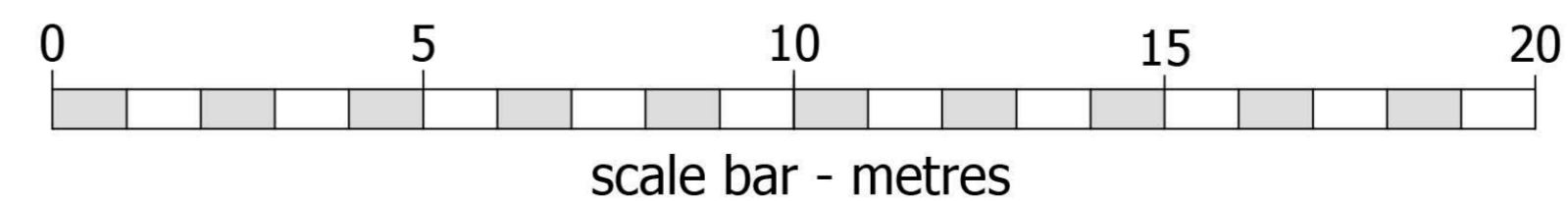

©CHURCHILL RETIREMENT LIVING

planning **issues**
TOWN PLANNING AND ARCHITECTURAL DESIGN
Rob Jackson RIBA
Churchill House * Parkside
Ringwood * Hampshire BH24 3EG
Telephone: 01429 442109
Fax: 01429 442101
E-mail: design@planningissues.co.uk

Client
Churchill Retirement Living

Project Title
Retirement Living Apartments
Edwina Mountbatten House
Romsey
SO51 8GH

Drawing Title
PROPOSED BYPASS ROAD A27 ELEVATION
PLANNING APPLICATION

Scale 1:100 @ A1 Date JUNE 2023
Drawn KLS Checked RJ
Drawing No. Rev.

10123RS - PA08 B